

DELCO ELECTRONICS DIVISION
GENERAL MOTORS CORPORATION KOKOMO, INDIANA

PART DESIGNED FOR MOUNTING TO 5.60 ± 0.08 DIA. HUB.

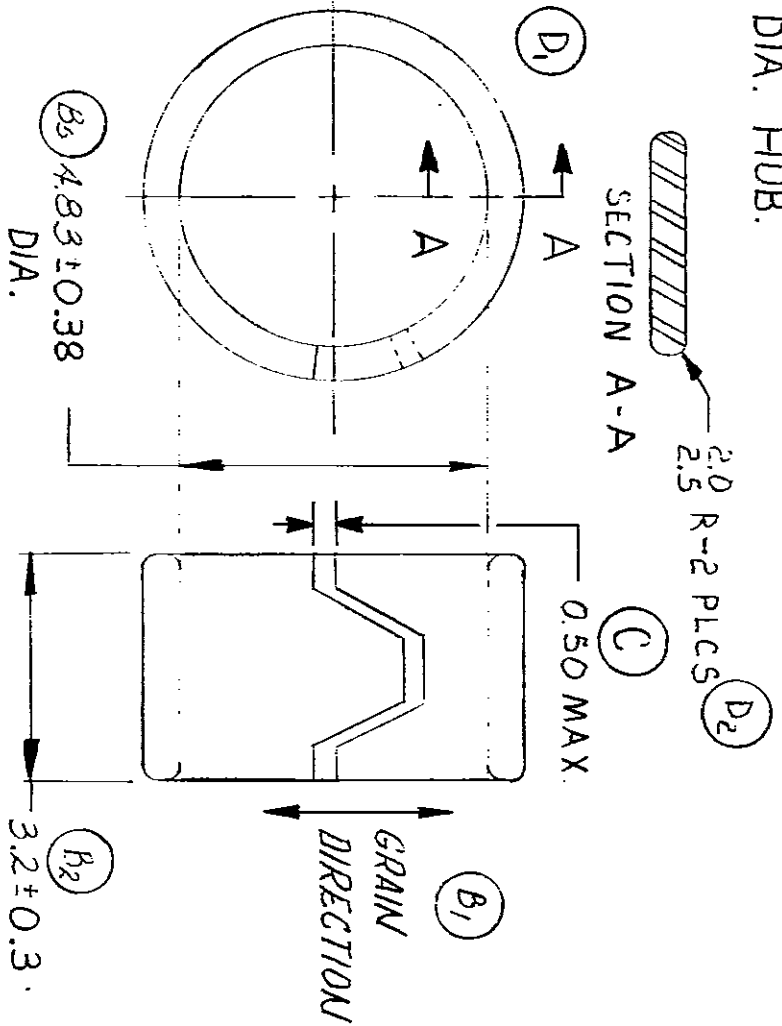

UNLESS OTHERWISE SPECIFIED:
DIMENSIONS ARE IN MILLIMETRES
MATL: SAE 1064 STEEL 0.40/0.50 THK. (B3) (D3)
HEAT TREAT TO ROCKWELL 45-50 C.
BLACK PHOSPHATE PER M10308.
REF: PART NO. C2301-017 (B4)

TINNERMAN PRODUCTS
P.O. BOX 6688
CLEVELAND, OHIO 44101

METRIC

NO. 16009155

DATE	SYM	REVISION RECORD	AUTH.	DR.	CK.
		NEW PARTS NOTICE			
8-18-78		COST - SALES DL-8908			
130C 78		COST - SALES DL-9077			
14N078	A	REDRAWN		DM	
30N078		REPLACED			
26A79		COST - SALES			
20N79	B	(1) HUBD GRN DIRECTION			
		NOTE (2) WAS 3.3 ± 0.3			
		(3) THICKNESS WAS 0.50			
		(4) PART N° WAS 242-			
19JL85	C	ADD'D 0.50 MAX DIM	55096	BS	11
14N085	D	1) ADD'D SECTION "A-A"	69158	BS	11
		2) ADD'D 2.0/2.5 R 2 PLCS			
		3) MATL WAS 0.43 THK	69422	BS	11

TOLERANCES UNLESS OTHERWISE SPECIFIED: DECIMALS ± NOTED FRACTIONS ±

DISTRIBUTION

CO	117		
F5			
A5			

DO NOT SCALE
DWG. 4-6-78 SCALE 10/1
DATE 10/1
DR. E. THOMAS

FIRST USED
16006596
CK. E. Thomas 15 NO 78
REFERENCE
7936077
APPR. [Signature]
MATERIAL SPEC.
NOTED

NAME
RING - COMP

EXP. MODEL DL-8908
PART NO. 16009155
EXP. NO. BX-40538