

Customer Information Sheet

DRAWING No.: H8078-01, H8079-01 SHEET 2 OF 2 IF IN DOUBT - ASK (C) NOT TO SCALE THIRD ANGLE PROJECTION ALL DIMENSIONS IN mm

NOTES:

1. RECOMMENDED MOUNTING HOLE = $\varnothing 1.32$ -1.22mm.
RECOMMENDED SPACING = 2.54mm PITCH GRID.
RECOMMENDED LEAD LENGTH = 2.80-4.45mm.
RECOMMENDED PCB SIZE = 1.52-3.18mm.
SOCKET MAY STAND PROUD OF PCB BY 0.76mm MAX.
2. SOCKET WILL ACCEPT AND RETAIN PINS RANGING FROM $\varnothing 0.58$ TO $\varnothing 0.66$ mm.
3. RTV SEAL PREVENTS SOLDER ENTERING SOCKETS DURING REFLOW OPERATIONS.

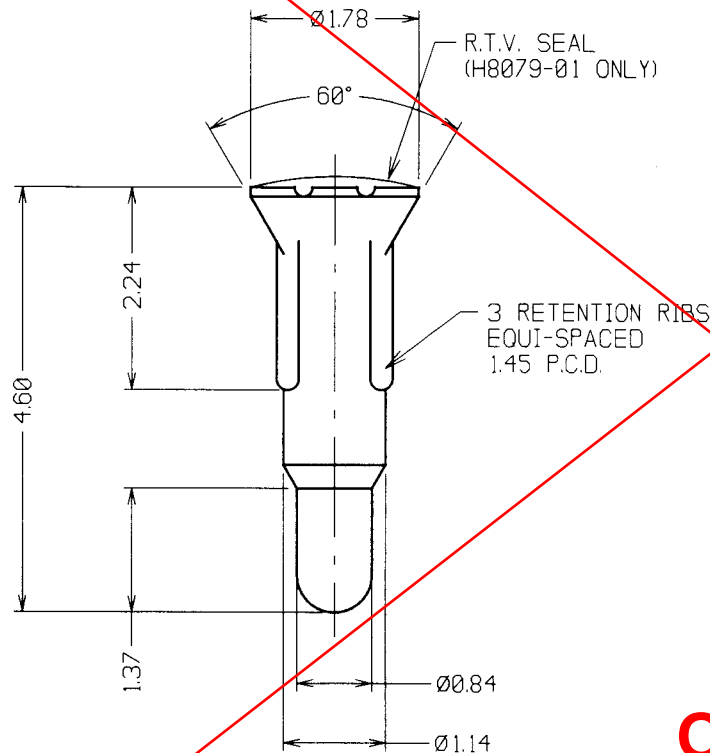

SPECIFICATION:

MATERIAL:
SHELL - GILDING MATERIAL (95/5 COPPER/ZINC)
CONTACT - BERYLLIUM COPPER

FINISH:
SHELL - 2.5μ TIN
CONTACT - 0.63μ GOLD

ELECTRICAL:
CURRENT RATING - 2 AMPS

MECHANICAL:
INSERTION FORCE ($\varnothing 0.635$ mm GAUGE) - 2.1N MAX
WITHDRAWAL FORCE ($\varnothing 0.635$ mm GAUGE) - 0.35N MIN
ALSO TESTED UNDER VIBRATION, MECHANICAL AND THERMAL SHOCK CONDITIONS.

OBSOLETE

JAE	5	31.07.03	7495
NAME	ISS.	DATE	C/NOTE
APPROVED: <i>[Signature]</i>			
CHECKED: <i>[Signature]</i>			
DRAWN: P. D. COLLINS			
CUSTOMER REF.:			
ASSEMBLY ORG.:			

HARWIN

HARWIN INC U.S.A. TEL: (812) 542 2546 FAX: (812) 542 2541	HARWIN PLC U.K. TEL: 023 9237 0451 FAX: 023 9231 4590	HARWIN PTE SINGAPORE TEL: 65 6779 4909 FAX: 65 6779 3868
--	--	---

THIS DRAWING AND ANY INFORMATION OR DESCRIPTIVE MATTER SET OUT HEREON ARE CONFIDENTIAL AND COPYRIGHT PROPERTY OF THE HARWIN GROUP AND MUST NOT BE DISCLOSED, LOANED, COPIED OR USED FOR MANUFACTURING, TENDERING OR FOR ANY OTHER PURPOSE WITHOUT THEIR WRITTEN PERMISSION

TOLERANCES
X - ± 1 mm
X.X - ± 0.25 mm
X.XX - ± 0.10 mm
X.XXX - ± 0.01 mm
ANGLES - $\pm 5^\circ$
UNLESS STATED

MATERIAL:
SEE ABOVE

FINISH: SEE ABOVE

S/AREA: mm²

TITLE:
SOCKET ($\varnothing 0.58$ TO $\varnothing 0.66$ mm PIN)

DRAWING NUMBER:
H8078-01, H8079-01

SHT 2 OF 2

Mouser Electronics

Authorized Distributor

Click to View Pricing, Inventory, Delivery & Lifecycle Information:

[Harwin:](#)

[H8078-01](#) [H8079-01](#)