

30–200/270 Amp (30–200A Load Breaking), Maximum 600VAC/250VDC
Load-Breaking Receptacles, Plugs, Connectors and Inlets

Receptacle Mounting Options — J-Line Construction

Progressive Assembly

Mounting Style	To Order Use:	Current Rating			
		30 Amp	60 Amp	100/150 Amp	200/270 Amp
Standard Series JRFA/JRSA □ 	Receptacle + Vertical or Square Mount Box + Angle Adapter	Basic Receptacle* + JB3-B100 1" Std. Conduit Size + JAA3 (20°) or JAA3-45 (45°)	Basic Receptacle* + JB6-B150 1d" Std. Conduit Size + JAA6-AB6 (20°) or JAA6-45 (45°)	Basic Receptacle* + JB10-B200 2" Std. Conduit Size + JAA10 (20°) or JAA10-45 (45°)	Basic Receptacle* + JB20 3" Std. Conduit Size + JAA20 (20°) or JAA20-45 (45°)
Series JRFR/JRSR □ Straight 	Receptacle + Vertical Mount Box + Straight Adapter	Basic Receptacle* + JB3-B100 1" Std. Conduit Size + JRA3	Basic Receptacle* + JB6-B150 1½" Std. Conduit Size + JRA6-AB6	Basic Receptacle* + JB10-B200 2" Std. Conduit Size + JRA10	Basic Receptacle* + JB20 3" Std. Conduit Size + JRA20
Series JRFB/JRSB □ 	Receptacle + 30° Angle Adapter	Basic Receptacle* + JAAB3	Basic Receptacle* + JAAB6	Basic Receptacle* + JAAB10	Basic Receptacle* + JAAB20
Series JRFE/JRSE □ 	Receptacle + Angle Enclosure	Basic Receptacle* + JE3 1" Std. Conduit Size	Basic Receptacle* + JE6 1½" Std. Conduit Size	Basic Receptacle* + JE10 2" Std. Conduit Size	N/A
Series JRFH/JRSH □ Horizontal 	Receptacle + Horizontal Mount Box + Angle Adapter	Basic Receptacle* + JB3-B100 1" Std. Conduit Size + JHA3 (20°)	N/A	N/A	N/A

* Select appropriate receptacle by rating, configuration and voltage on page 59.

□ NOTE: JRXX 3rd letter denotes Flap (F) or Screw (S) Cover.

Ex: JRSA — Screw Cover

JRFA — Flap Cover

JRF — Flap Cover, Basic Receptacle

JRS — Screw Cover, Basic Receptacle

30–200/270 Amp (30–200A Load Breaking), Maximum 600VAC/250VDC
Load-Breaking Receptacles, Plugs, Connectors and Inlets

Plugs and Connectors

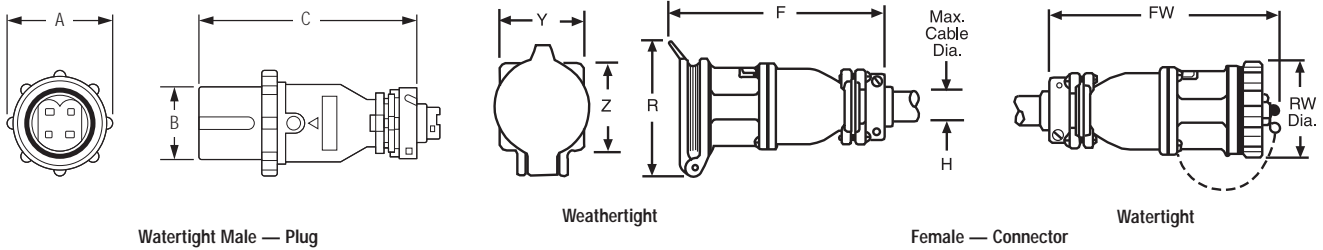

Dimensions for 2-, 3- or 4-Wire Weathertight and Watertight Units

AMP	WEATHERTIGHT		WATERTIGHT		WEATHERTIGHT		WATERTIGHT		Y	Z	H
	A	B	C	F	FW	R	RW				
30	3"	2 ⁷ / ₈ "	7"	8 ⁷ / ₈ "	8 ⁷ / ₈ "	4 ¹ / ₄ "	3"	2 ³ / ₄ "	2 ³ / ₄ "	1	
60	3 ³ / ₄ "	2 ⁵ / ₈ "	8 ⁷ / ₈ "	10 ³ / ₄ "	10 ³ / ₈ "	5"	3 ³ / ₄ "	3 ¹ / ₂ "	3 ¹ / ₂ "	3 ³ / ₈ "	
100/150	4 ¹ / ₈ "	2 ¹¹ / ₁₆ "	10 ¹ / ₄ "	10 ¹ / ₂ "	10 ⁷ / ₈ "	5 ¹ / ₄ "	4 ¹ / ₈ "	4"	4"	1 ¹ / ₈ "	
200/270	5 ¹ / ₄ "	3 ¹¹ / ₁₆ "	14 ⁵ / ₈ "	14 ⁷ / ₈ "	15 ¹ / ₈ "	7 ¹ / ₈ "	5 ³ / ₄ "	5 ⁵ / ₈ "	5 ⁵ / ₈ "	2 ¹ / ₂ "	

Basic Receptacles

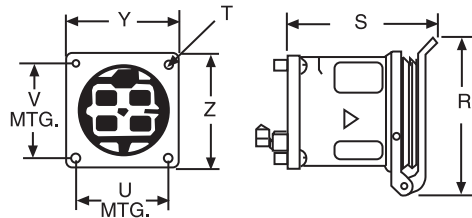

Dimensions for 2-, 3- or 4-Wire Units

AMP	WEATHERTIGHT		WATERTIGHT		WEATHERTIGHT		WATERTIGHT		V	U	T
	Z	Y	X	S	SW	R	RW				
30	2 ³ / ₄ "	2 ³ / ₄ "	1	3 ³ / ₈ "	3 ³ / ₄ "	4 ¹ / ₄ "	3"	2 ¹ / ₄ "	2 ¹ / ₄ "	1 ¹ / ₄ "	
60	3 ¹ / ₂ "	3 ¹ / ₂ "	1 ¹ / ₄ "	4 ¹ / ₈ "	4 ¹ / ₄ "	5"	3 ³ / ₄ "	2 ¹ / ₈ "	2 ¹ / ₈ "	3 ¹ / ₃₂ "	
100/150	4"	4"	1 ¹ / ₄ "	5"	5 ¹ / ₄ "	5 ¹ / ₄ "	4 ¹ / ₈ "	3 ³ / ₈ "	3 ³ / ₈ "	3 ¹ / ₃₂ "	
200/270	5 ⁵ / ₈ "	5 ⁵ / ₈ "	1 ³ / ₄ "	6 ¹ / ₈ "	6 ¹ / ₈ "	7 ¹ / ₈ "	5 ³ / ₄ "	4 ¹ / ₈ "	4 ¹ / ₈ "	1 ¹¹ / ₃₂ "	

Russellstoll®

J-Line™ Dimensions

Heavy Industrial/Marine — J-Line™

Panel Mount Series

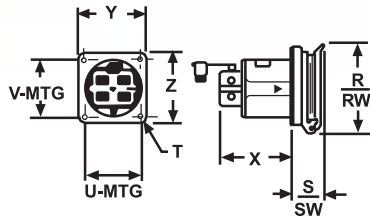

Standard Series JRFA/JRSA

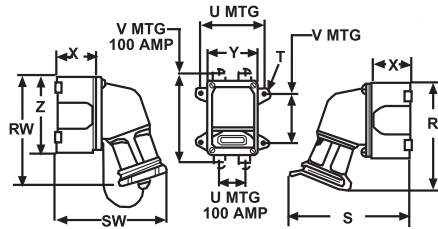

Series JRFR/JRSR

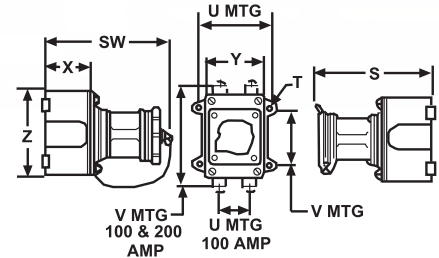

Series JRFB/JRSB

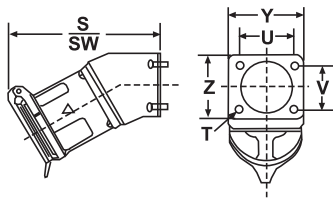

Series JRFE/JRSE

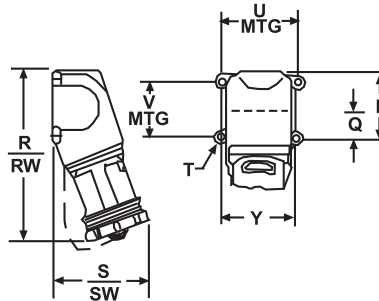

Series JRFH/HRSH

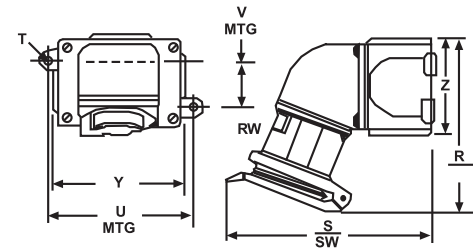

WEATHERTIGHT

AMP	SERIES	Z	Y	X	S	SW	R	RW	Q	P	V	U	T	PANEL OPENING	
30	Panel Mount	3½"	3½"	2½"	1¾"	2"	4¼"	3"	—	—	2⅞"	2⅞"	¼"	2¾"	
	Standard (20°)	4½"	3"	2⅞"	7"	6½"	6¼"	6¼"	—	—	2⅞"	3⅞"	¼"	—	
	JRFR/JRSR	4½"	3"	2⅞"	6⅞"	6½"	—	—	—	—	2⅞"	3⅞"	¼"	—	
	JRFB/JRSB	3⅞"	3⅞"	—	5¼"	5¾"	—	—	—	—	—	2¼"	2¼"	¼"	2¼"
	JRFE/JRSE	—	3½"	—	5¼"	4⅞"	7⅞"	7⅞"	1¼"	2⅞"	—	4	¼"	—	
	JRFH/HRSH	3⅞"	4½"	2⅞"	7"	6½"	6⅞"	6⅞"	—	—	2⅞"	3⅞"	¼"	—	
60	Panel Mount	4"	4"	3⅞"	1¾"	2"	5"	3¼"	—	—	3⅞"	3⅞"	⅝"	3¼"	
	Standard (20°)	5⅞"	4"	3"	9¼"	8⅞"	8⅞"	9"	—	—	3⅞"	4⅞"	1⅜"	—	
	JRFR/JRSR	5⅞"	4"	3"	8⅞"	8½"	—	—	—	—	3⅞"	4⅞"	1⅜"	—	
	JRFB/JRSB	3⅞"	3⅞"	—	7⅞"	7⅞"	—	—	—	—	2⅞"	2⅞"	⅝"	2½"	
	JRFE/JRSE	—	4¼"	—	6⅞"	5¾"	9¼"	9½"	1⅞"	3⅞"	3⅞"	4½"	⅝"	—	
100/150	Panel Mount	4¼"	4¼"	4⅞"	1¾"	2"	5¼"	4⅞"	—	—	3⅞"	3⅞"	⅝"	3½"	
	Standard (20°)	5½"	5½"	3½"	10½"	9⅞"	9⅞"	9¼"	—	—	6¼"	4⅞"	1⅜"	—	
	JRFR/JRSR	5½"	5½"	3½"	11¼"	11⅞"	—	—	—	—	6¼"	4⅞"	1⅜"	—	
	JRFB/JRSB	3⅞"	3⅞"	—	8¼"	8¼"	—	—	—	—	2⅞"	2⅞"	⅝"	—	
200/270	Panel Mount	6"	6"	5⅞"	2"	2½"	7⅞"	5¼"	—	—	5¼"	5¼"	1⅜"	5⅞"	
	Standard (20°)	8⅞"	8⅞"	6⅞"	15⅞"	15⅞"	12⅞"	12⅞"	—	—	9⅞"	7⅞"	⅝"	—	
	JRFR/JRSR	8⅞"	8⅞"	6⅞"	15"	15½"	—	—	—	—	9⅞"	7⅞"	⅝"	—	
JRFB/JRSB	4"	4"	—	12¼"	12¼"	—	—	—	—	—	2¼"	2¼"	1⅜"	—	

NOTE: U = horizontal mounting hole centers; V = vertical mounting hole centers.